

Pitch: 3.81mm(0.150inch)



SPECIFICATIONS

		CUL		VDE
負載電壓	Rated Voltage	Bemessungsspannung	AC 300V	
負載電流	Rated Current	Bemessungsstrom	8A	
電線線徑	Wire Size	Leitergrößen	26~16AWG	
塑膠本體	Housing Material	Isolierstofftyp	Polyamide66(UL94V-0)	
押線圈	Cage Clamp	Klemmkörper	Brass, Ni plated	
端子	Terminal	Stiftmaterial	Brass, Tin plated	
螺絲	Screw Size	Schraubengewinde	M2.0, steel, Ni plated	
操作溫度	Operating Temperature	Umgebungstemperatur	-40°C to + 105°C	
扭力	Torque	Anzugsmoment	3.0 lb-inch	
PC板孔徑	PCB Hole Diameter	Lochdurchmesser	φ 1.3mm	
UL File No.	E167040			

TABLE

Item No.	A(mm)	A(inch)
MB332-381M02	7.6	0.300
MB332-381M03	11.4	0.450

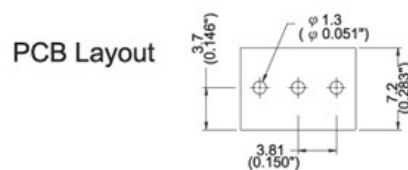
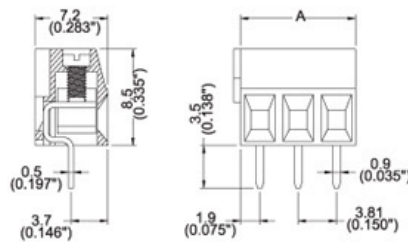

Note:
Screw Plating: Changes are available upon request